

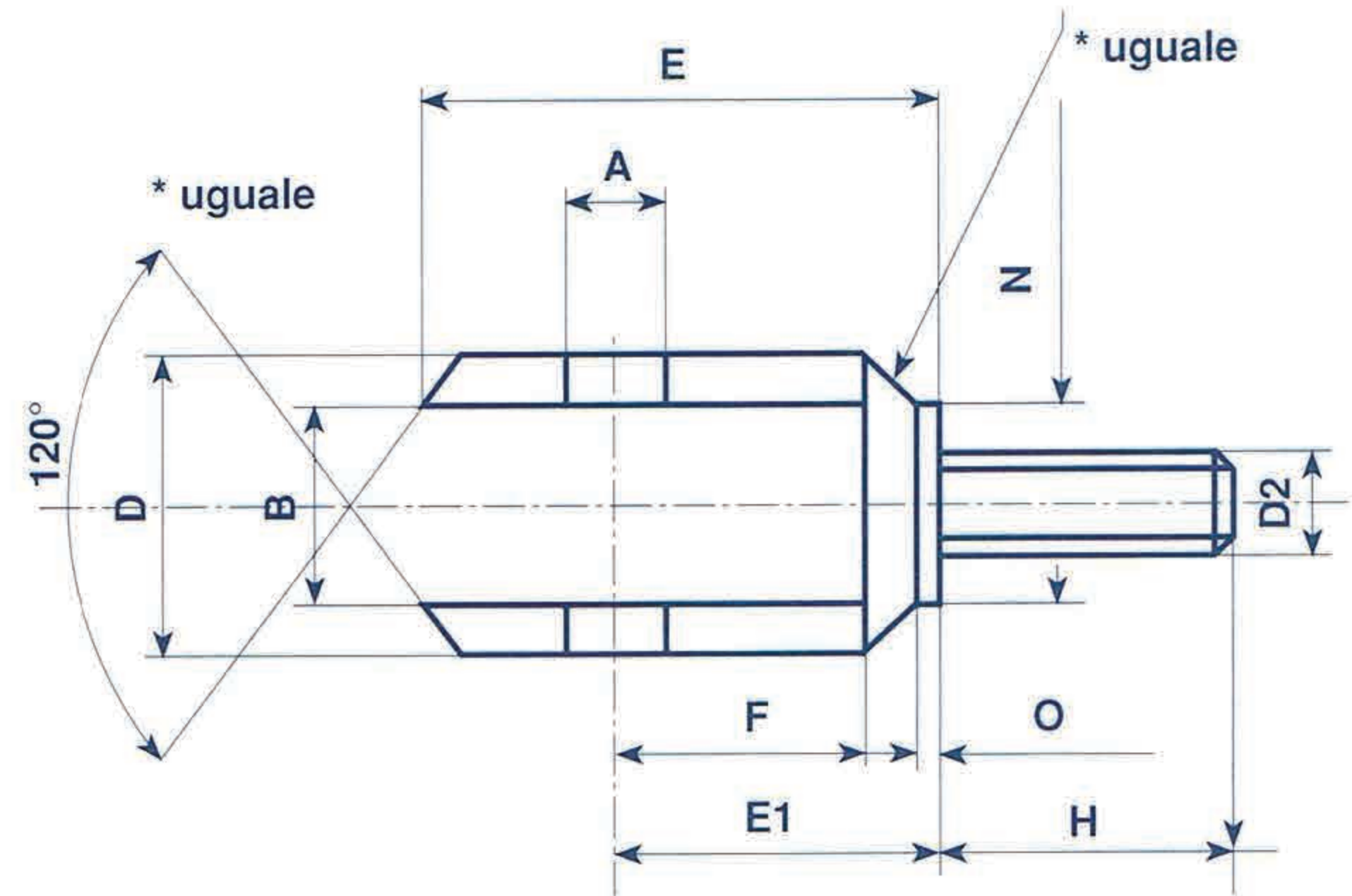

## FORCELLA FE

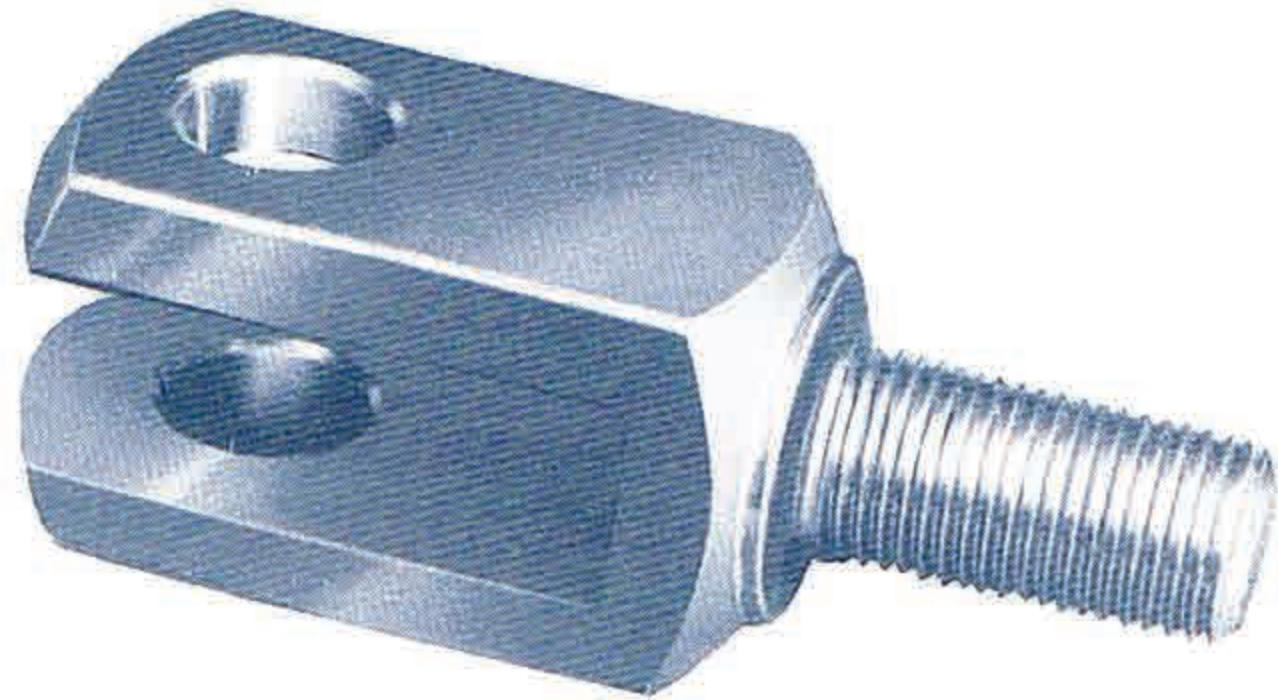

ACCIAIO - STEEL - ACIER - STAHL 9S Mn Pb 23 R 50 Kg./mm<sup>2</sup>

TIPO	ØA	B	D	D <sub>2</sub>	E	E <sub>1</sub>	F	H	N	O	CODICE
<b>FF 10</b>	10	10	20	<b>M 10 x 1,25</b>	39	27	20	22	18	2	<b>F-FE 10</b>
<b>FF 12</b>	12	12	24	<b>M 12 x 1,25</b>	46	32	24	24	20	2	<b>F-FE 12</b>
<b>FF 16</b>	16	16	32	<b>M 16 x 1,5</b>	61	42	32	32	27	2	<b>F-FE 16</b>
<b>FF 20</b>	20	20	40	<b>M 20 x 1,5</b>	77	52	40	40	34	2,5	<b>F-FE 20</b>
<b>FF 27</b>	25	25	50	<b>M 27 x 2</b>	98	66	50	43	42	2,5	<b>F-FE 27</b>