

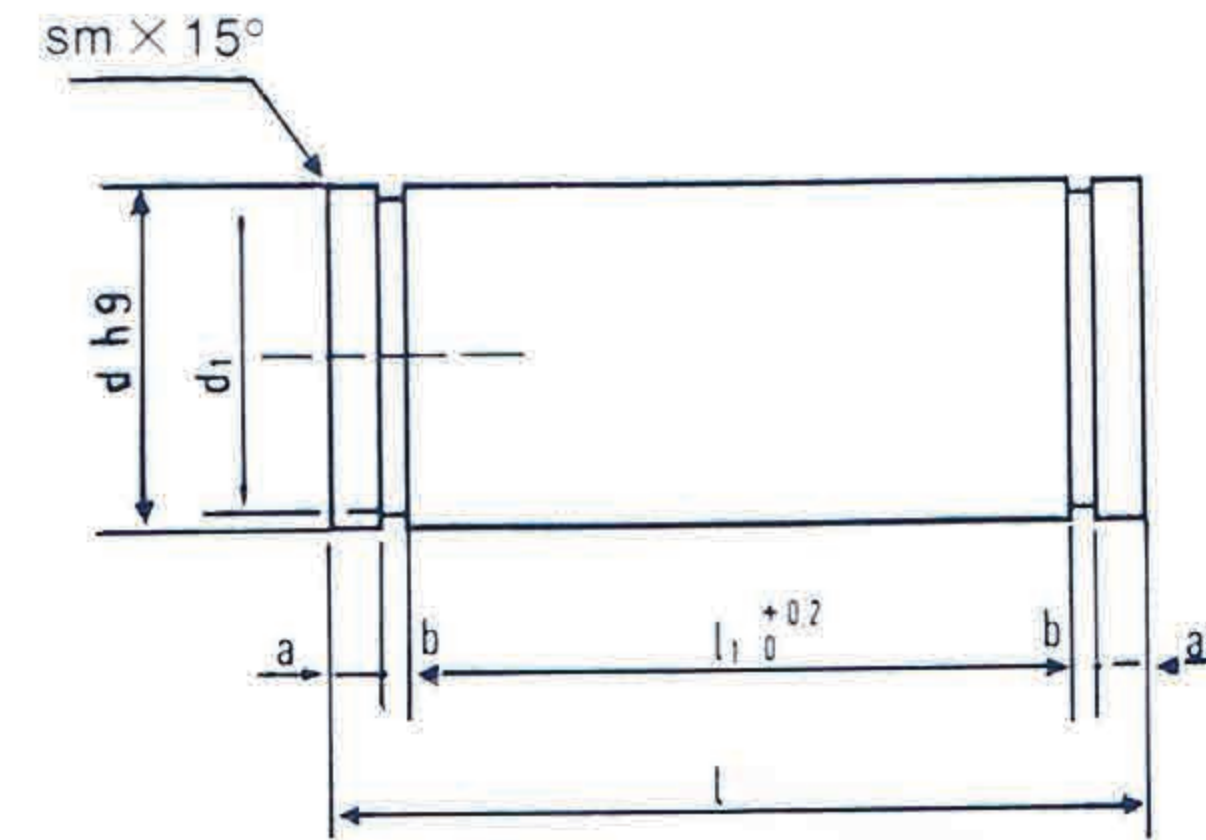

PERNI PER FORCELLE **CNOMO** CLEVIS PINS - TOURILLON - BOLZEN

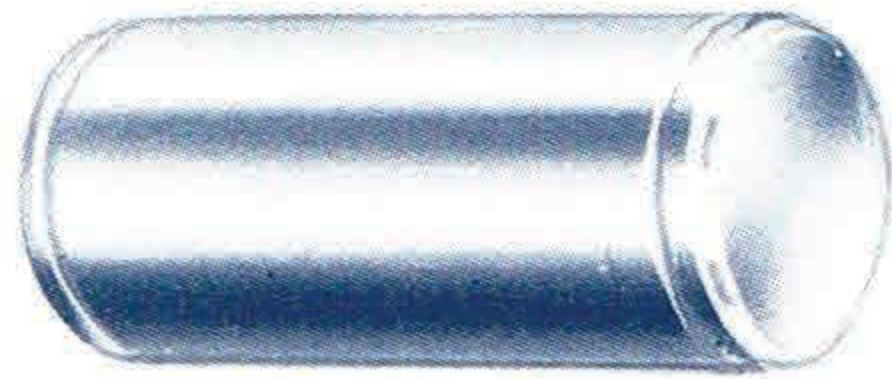

ACCIAIO - STEEL - ACIER - STAHL 9S Mn Pb 23 R 50 Kg./mm²

PERNI - CNOMO	d	l	d ₁	l ₁	a	b	CODICE
10	8	30	7,6	22	3	0,9	P-CNOMO 10
16	12	45	11,5	36	3,5	1,1	P-CNOMO 16
20	16	55	15,2	45	3,9	1,1	P-CNOMO 20
27	20	75	19	63	4,9	1,3	P-CNOMO 27
36	25	95	23,9	80	6,2	1,3	P-CNOMO 36